

**CONFERENCE & ROOM DIMENSIONS**

Dimensions	Great Barn		Small Barn	Whole Suite	Board Room 1	Board Room 2	Whole Centre
	Main Room	Extension	Barn				
Length Feet	101	20	54	155	23	23	-
Metres	30.6	6	16.3	47.1	7.1	7.1	-
Width feet	22	24	24	22	23	23	-
Metres	6.7	7.5	7.4	6.7	7.1	7.1	-
Area Sq. feet	2222	480	1296	3518	529	529	1292
Area Sq. metres	206	45	120	326	50.5	50.5	123

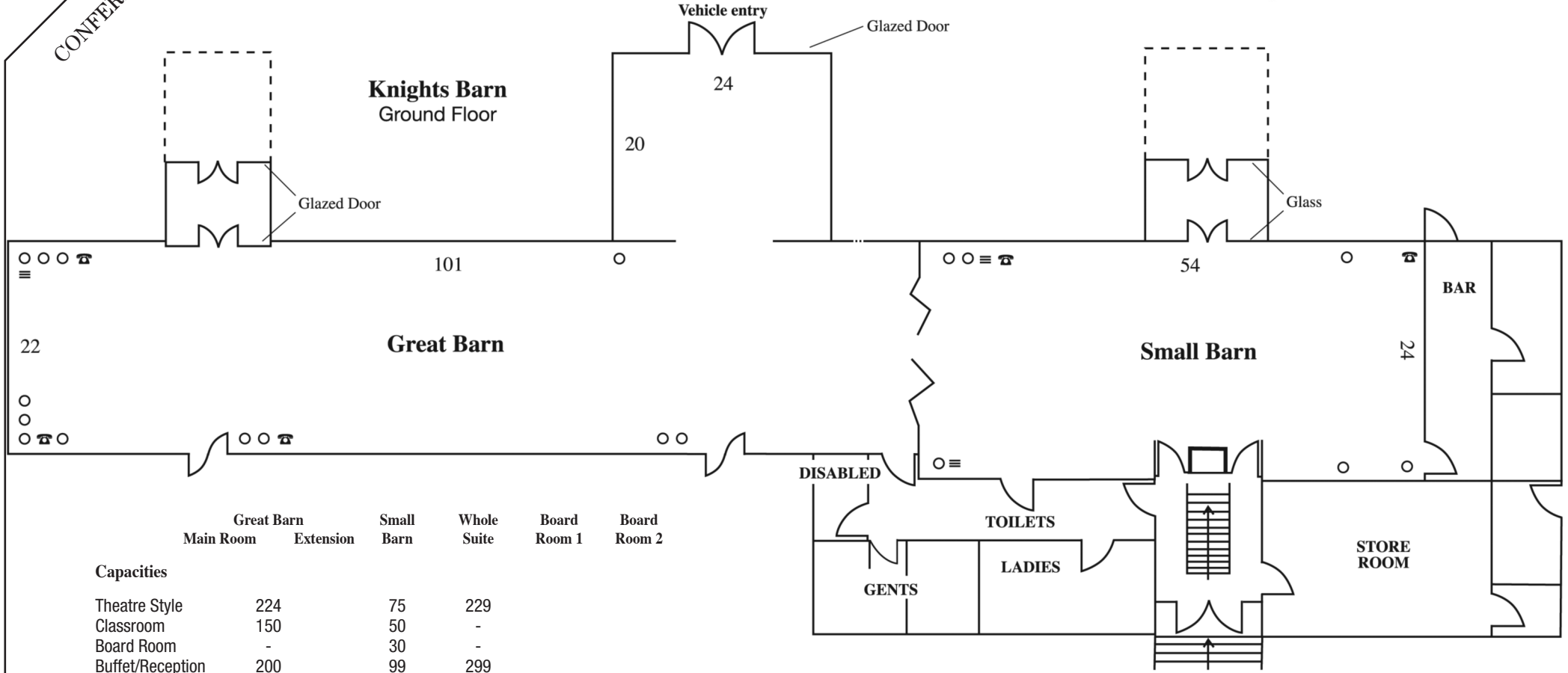
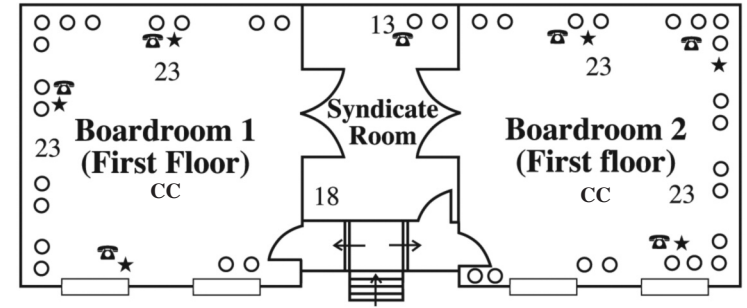

Capacities	Great Barn		Small Barn	Whole Suite	Board Room 1	Board Room 2
	Main Room	Extension	Barn			
Theatre Style	224		75	229		
Classroom	150		50	-		
Board Room	-		30	-		
Buffet/Reception	200		99	299		
Dinner/Dance	200		50	200		
Dinner	250		60	250		
Informal meeting	-		-	-		
U-Shaped	40		30	-	16	16
Cabaret	72		30	-		

- Key to Plans**
- Microphone socket
  - 13 amp socket
  - WW Folding or removable partition
  - ★ Broadband point
  - ☎ Telephone point
  - ▤ Door
  - CC climate control

60 amp Three Phase Power available in Great and Small Barns

CONFERENCE & ROOM DIMENSIONS

**Captains Room**  
Ground Floor

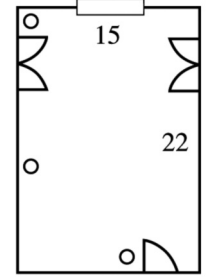

**Admirals Room**  
Ground Floor

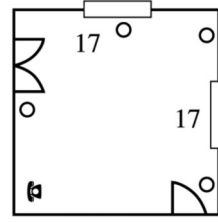

**Library**  
Ground Floor

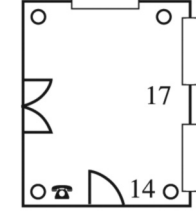

**Study**  
Ground Floor

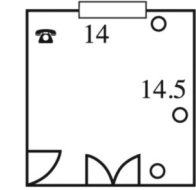

**Key to Plans**

- 13 amp socket
- ☎ Telephone point
- ▤ Door

	Captains Room	Admirals Room	Library	Study
<b>Dimensions</b>				
Length Feet	22	17	14	14
Metres	6.7	5.25	4.25	4.25
Width feet	15	17	17	14.5
Metres	4.5	5.25	5.25	4.5
Area Sq. feet	330	289	238	203
Area Sq. metres	30	27.5	22	19
<b>Capacities</b>				
Theatre Style	-	-	-	-
Classroom	-	-	-	-
Board Room	14	12	-	-
Buffet/Reception	-	-	-	-
Dinner/Dance	-	-	-	-
Dinner	14	-	-	-
Informal meeting	-	-	10	6
U-Shaped	-	-	-	-
Cabaret	-	-	-	-

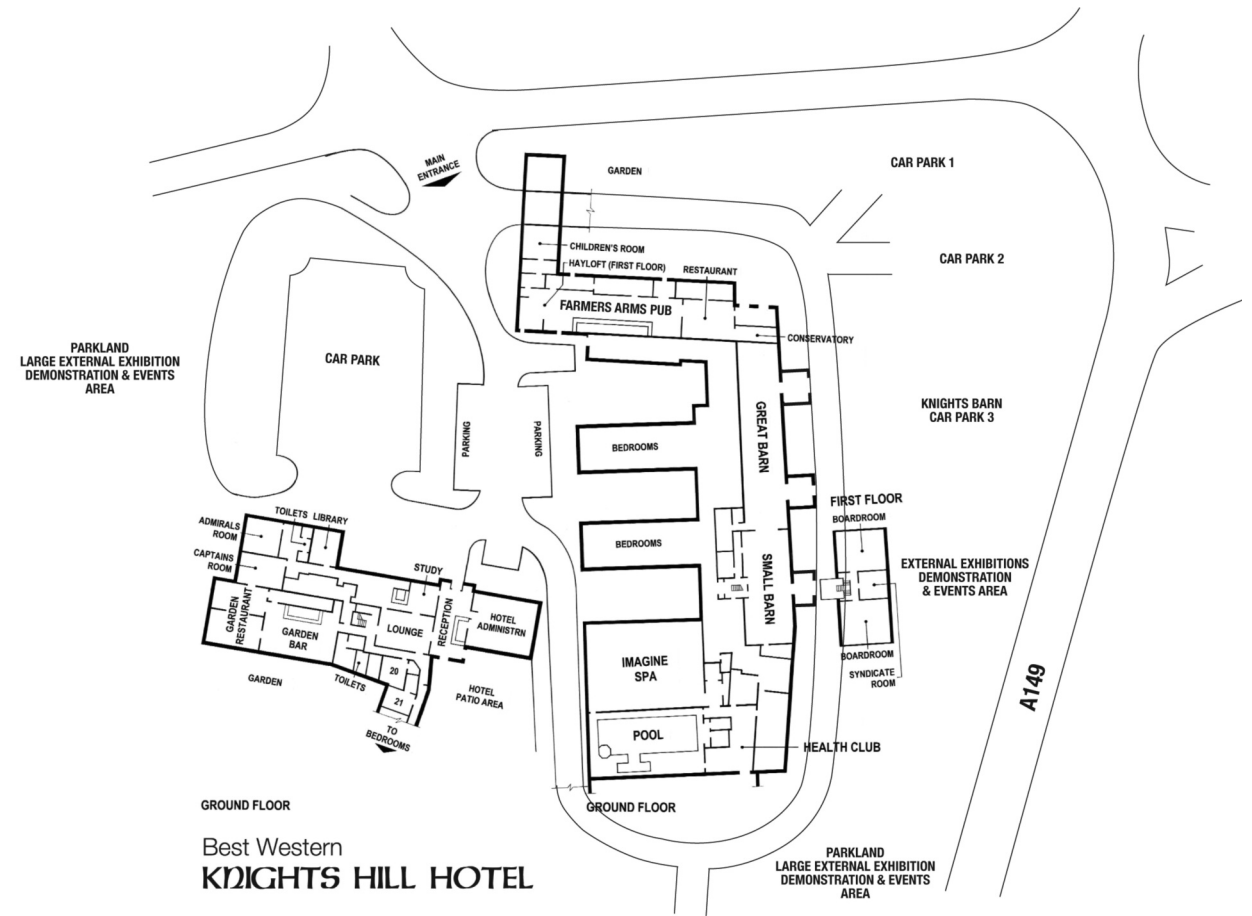

GROUND FLOOR  
Best Western  
**KNIGHTS HILL HOTEL**